



PeerlessBoilers.com

PUREFIRE® PF to PFW Instructions

Heating Boiler to Hot Water Supply Boiler Conversion

⚠ WARNING

Conversion of a PureFire boiler from a heating boiler to a hot water supply boiler is to be performed by a qualified contractor in accordance with these instructions and with the hot water supply boiler installation, operation and maintenance instructions included with the conversion kit. All applicable codes and requirements of the authority having jurisdiction shall be followed. The installation is not complete until the operation of the converted boiler is checked.

⚠ WARNING

If the information in these instructions is not followed exactly, a fire, explosion or production of carbon monoxide may result causing property damage, personal injury or loss of life.

Stop! Read these instructions or the appliance warranty will be void!

Items included in the conversion kit:

- | | |
|--|--------|
| 1) Safety Relief Valve – Set at 125 psig | 54274 |
| 2) Pressure/Temperature Gauge – 0-200 psig/70°F to 320°F | 54275 |
| 3) Storage Tank Temperature Sensor – 12kΩ thermistor | 54157 |
| 4) Flow Switch – 1" NPT | 29017 |
| 5) Boiler Display – PFW hot water supply boiler | 54646 |
| 6) Lead free brass pipe and fittings | - |
| 7) Terminal Labels | 9502 |
| 8) PureFire PFW installation, operation and maintenance instructions | PF8234 |

⚠ NOTICE

This hot water supply boiler is designed to operate in conjunction with a storage tank with constant flow throughout the heating cycle. Failure to install and operate the system in accordance with the PFW manual may result in poor performance and or damage to the equipment.

STEP 1

Be sure that electrical power is disconnected from the unit before beginning the conversion.

STEP 2

Separate safety relief valve, pressure/temperature gauge, outdoor sensor and the PF Installation, Operation and Maintenance Instructions (PF8080 or PF8234) supplied with the heating boiler to avoid confusion regarding parts and instructions. Remove the existing display by depressing the tab at the bottom center of the cover and keep this with the heating boiler parts.

STEP 3

Install new PFW display onto the existing sub-base by inserting the hinge tabs at the top of the display and gently snapping the bottom into place. See Figure 1.

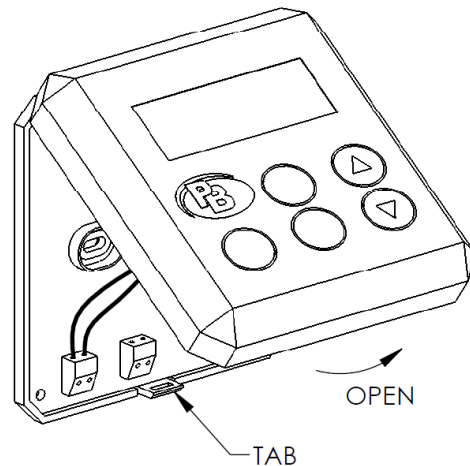

Figure 1: Display Connection

PUREFIRE® PF to PFW Instructions

Heating Boiler to Hot Water Supply Boiler Conversion

STEP 4

Apply Terminal Labels as shown in Figure 2. Be sure that the labels line up directly with all of the terminals. The boiler can be damaged by misapplication of electrical power.

STEP 5

Install hot water supply boiler in accordance with the PFW Installation, Operation and Maintenance Instructions (PF8234)

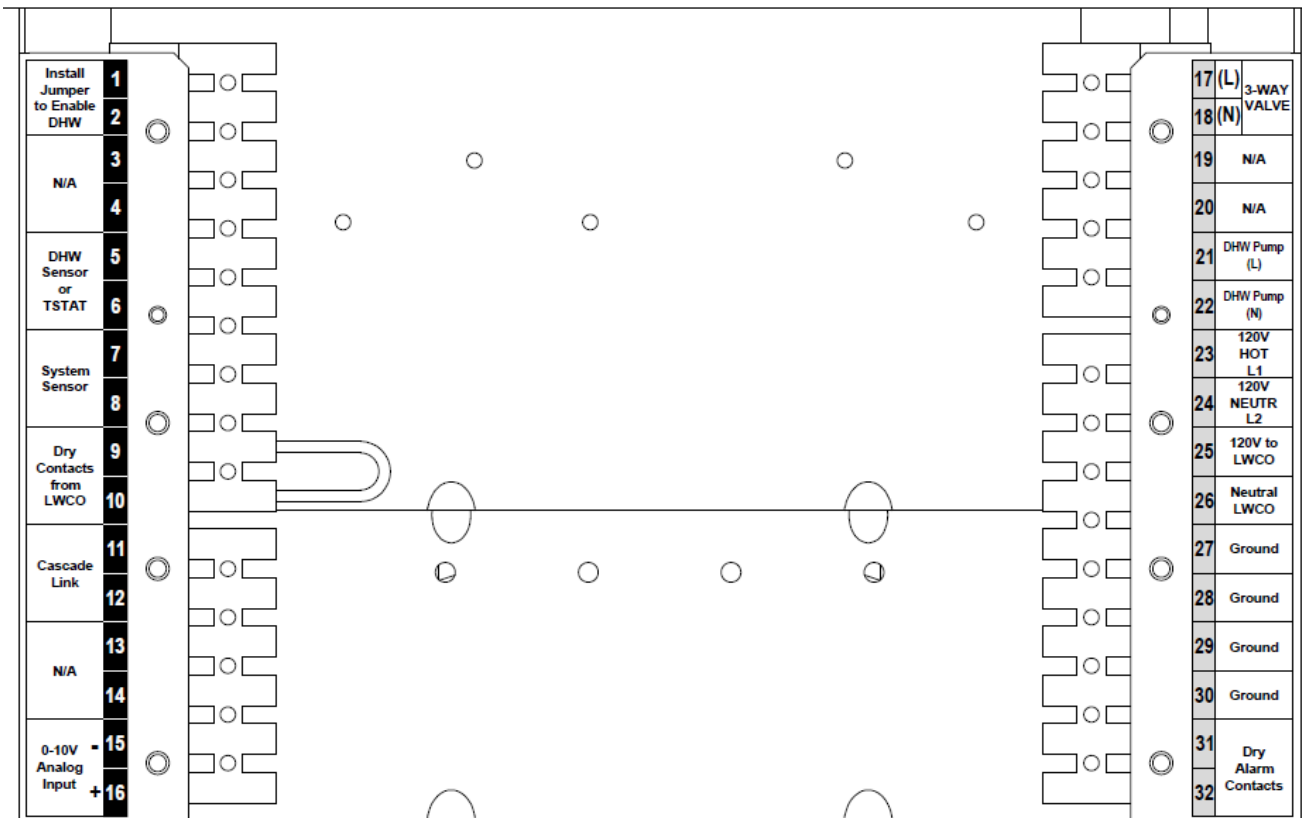

Figure 2: Electrical Terminal Label Application



PeerlessBoilers.com

PB HEAT, LLC

131 S. CHURCH STREET • BALLY, PA 19503