



BURNER SPEC & DATA SHEET

SERIES TCII™ **POWER FLAME MODEL “J” BURNER** **FOR GAS**

STANDARD EQUIPMENT

Gas Burners:

1. Lo-Hi-Lo operation on Models TCII-04 through TCII-07 boilers.
2. 30 second pre-purge/0 second post-purge – Models TCII-04 and TCII-05 boilers.
3. 90 second pre-purge/0 second post-purge – Models TCII-06 through TCII-07 boilers.
4. Spark ignited gas pilot.
5. Air flow safety switch.

OPTIONAL EQUIPMENT

1. Full modulation burner operation for boilers with standard Lo-Hi-Lo.
2. Burner mounted control panel with on/off control switch, power-on and main fuel lights and terminal strip.
3. Air flow switch on oil burners.
4. Step-down control circuit transformer and control circuit fuse.
5. Controls to comply with FM Former IRI, CSD-1, and other codes. Contact your local Peerless® Representative or PB Heat, LLC for availability.
6. Various combustion controls. Contact your local Peerless® Representative or PB Heat, LLC for availability.
7. Various burner motor voltages: 120/1/60, 230/1/60, 208-230/460/3/60.

POWER FLAME MODEL "J" BURNER - BURNER CHARACTERISTICS FOR GAS FIRING

BOILER MODEL	INPUT (1)	OVERFIRE PRESSURE IN. W.C. (2)	STANDARD BURNER MODEL	INITIAL AIR SETTINGS (3) INCHES		
	GAS MBH			DIFF.	TOP	BOTTOM
TCII-04	1143	0.36	J50A-15	1/4	7/8	7/8
TCII-05	1458	0.59	J50A-15	1/2	1	1
TCII-06	1773	0.82	J50A-15	3/8	3/8	3/8
TCII-07	2088	0.46	J50A-15	3/8	3/8	3/8

(1) Based on Commercial Standard Number 2 fuel oil with a heating value of 140,000 BTU/gal. and Natural Gas with a heating value of 1000 BTU/cubic foot and 0.60 specific gravity at a maximum altitude of 2000 feet above mean sea level. Consult the factory for higher altitudes.

(2) With 0.10 inch W.C. at flue outlet and at Input.

(3) Start-up settings only. Final settings are to be determined using combustion analysis equipment.

POWER FLAME MODEL "J" BURNER FOR GAS

BOILER MODEL	STANDARD COMBUSTION CONTROL	3450 RPM MOTOR HP	STANDARD VOLTAGE VOLTS/PHASE/HERTZ
TCII-04	RM7897A	1/2	115/1/60
TCII-05	RM7897A	1/2	115/1/60
TCII-06	RM7897A	1/2	115/1/60
TCII-07	RM7897A	1/2	115/1/60

POWER FLAME MODEL "J" BURNER - BURNER CHARACTERISTICS FOR GAS FIRING

BOILER MODEL	GAS ORIFICE			GAS CONTROL TRAIN			GAS MANIFOLD PRESSURE (IN. W.C.)	GAS TRAIN PRESSURE DROP (IN. W.C.)
	QTY	SIZE INCH	SIDE INCH	SIZE NPS (1)	INLET PRESSURE (IN. W.C.)			
					MINIMUM	MAXIMUM		
TCII-04	30	9/64	7/8	1.25	5.0	14.00	3.9	2.04
TCII-05	30	9/64	1	1.25	5.7	14.00	3.3	3.81
TCII-06	40	11/64	1-1/4	1.50	6.6	14.00	3.1	3.72
TCII-07	40	11/64	None	1.50	9.2	14.00	3.0	5.71

(1) On dual size gas train, first number is the main gas valve, aux. gas valve, and leakage test cock. The second number is the main shutoff cock and gas pressure regulator.

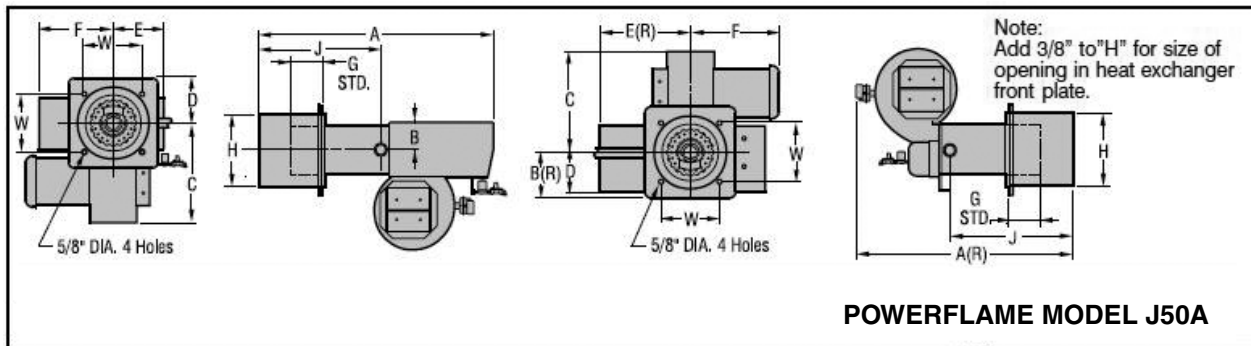

BURNER MODEL	DIMENSIONS, INCHES													
	A	A (R)	B	B (R)	C	D	E	E (R)	F	G		H	J	W
										STD	MAX			
J50A	29-3/4	27-3/4	4-3/8	5-1/8	14	5-1/4	8-1/2	11-1/4	11-3/4	3-3/4	12-1/4	8-1/8	13-5/8	8-1/4

PB HEAT, LLC

131 S. CHURCH STREET • BALLY, PA 19503